

NOTE:

- Proposals must comply with all acoustic, fire & building regulation requirements
- No dimensions are to be scaled from this drawing. The contractor is responsible for checking all dimensions on site

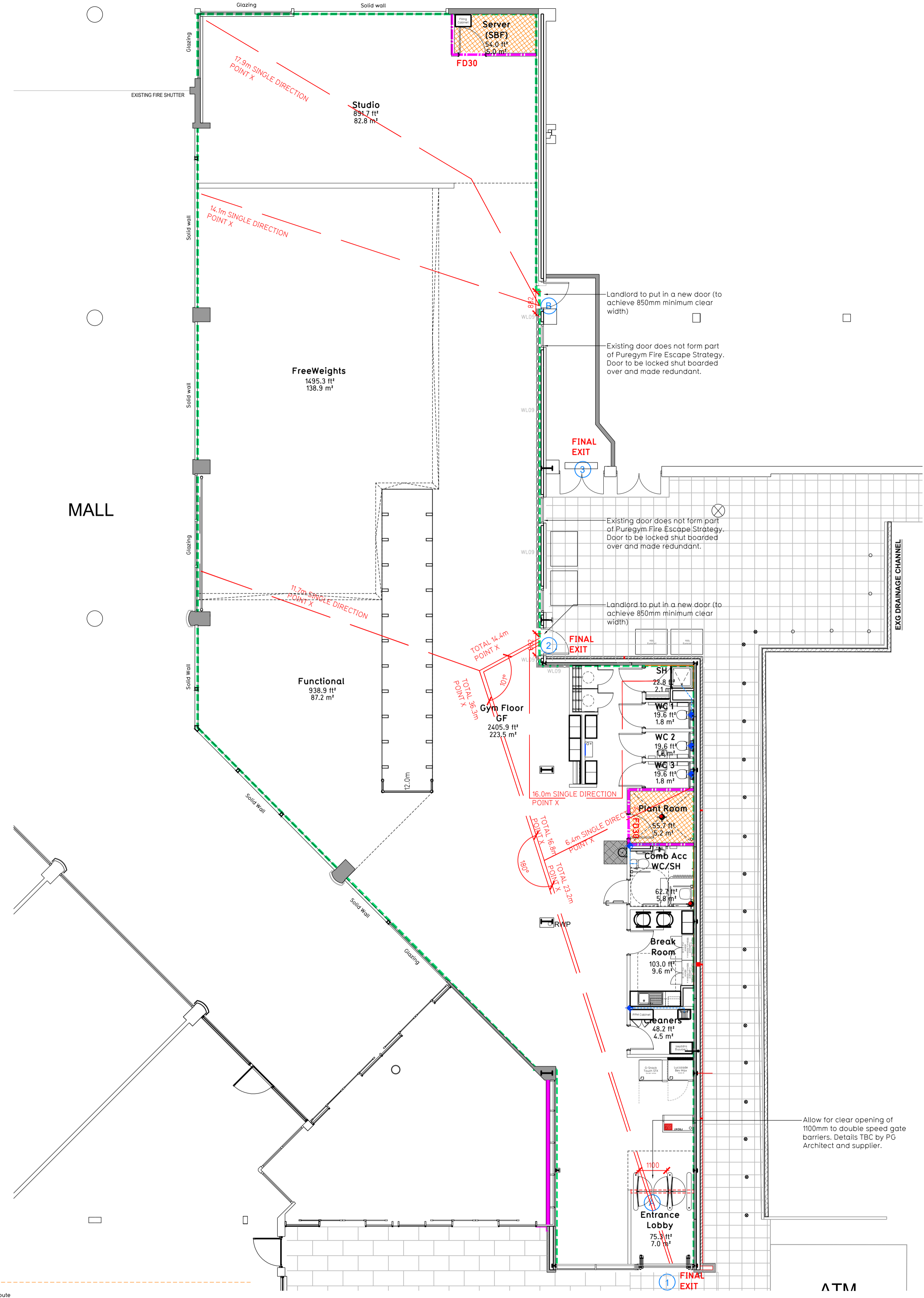

Fire Evacuation Key

	Existing wall to achieve min 30 minute fire rating (suitability of wall to be confirmed on site by Pure Gym Main Contractor)		Fire Escape Route
	Existing wall to achieve min 60 minute fire rating (suitability of wall to be confirmed on site by Pure Gym Main Contractor)		Minimum Clear Widths
	New wall to achieve min of 30min fire rating		Exit No.
	New wall to achieve min of 60min fire rating		Shared Escape Route
	Protected areas: walls, floors, ceilings and doors to achieve 30minute fire resistant construction.		Fire Door Rating
	Protected areas: walls, floors, ceilings and doors to achieve 60 minute fire resistant construction.		

Escape Route Widths:
 In line with Tables 2.3, 2.4, 2.5 & 2.6 of 'Technical Booklet E - Fire Safety' for Northern Ireland - the adjacent calculations provide justification for the clear opening widths for escape from each floor level / room.

Ground Floor:
 Final Exit 1 limited by Storey Exit A Clear Opening Width = 1100mm (allows 220 persons to escape, largest opening to be discounted)
 Final Exit 2 Clear Opening Width = 882mm (allows 110 persons to escape)
 Final Exit 3 limited by Storey Exit B Clear Opening Width = 882mm (allows 110 persons to escape)

Total Aggregate Width for Floor (Less Largest Opening Width of 1100mm from FINAL EXIT 1) = 1764mm

Total Ground Floor = 220 persons to escape

Based on IA at 654sqft, the Puregym Peak Occupancy Target = 100 Persons
 Calculated using Puregym Fire Safety Occupancy Levels Forecast Tool.

The designed occupancy of the unit as calculated would allow a max. No. 220 persons to escape, which is larger than the total estimated occupancy capacity of 100 persons and is therefore thought to meet with the 'Technical Booklet E - Fire Safety for Northern Ireland'.

Fire Alarm:
 Fire Alarm designed and installed to BS 5839. Smoke & heat detection / emergency lighting by specialist. Please refer to MSE engineer's drawings / specifications.

Escape Lighting:
 Emergency escape lighting designed and installed in accordance with BS 5266: Part 1. Please refer to MSE Engineer's drawings for final layout and specification.

Escape Signage and emergency lighting is CDP under the MSE specification. Details of contractors proposals to be provided to Building Control Approved Inspector and Fire Officer within the Contractors Proposals Package, Clause 14.

Automatic speed gates to fall safe to the open position upon sounding of the fire alarm with a 3hr battery backup

Rev	Date	Description	DRAWING TITLE	Drawn/ Checked
Dungannon NI Units A-D, Oaks SC, Oaks Rd, BT71 4NA			Fire Evacuation Plan Ground and First Floor Plans	
OT/CS	06.03.23	SCALE	1:100 @ A1	2243
DRAWING PURPOSE			003-FEP	Rev
CONSTRUCTION				C00

PUREGYM

Pure Gym Ltd
 Town Centre House
 The Merrion Centre
 Leeds
 LS2 8LY
 e: architecture@puregym.com
 t: 0113 285 8787
 w: www.puregym.com